

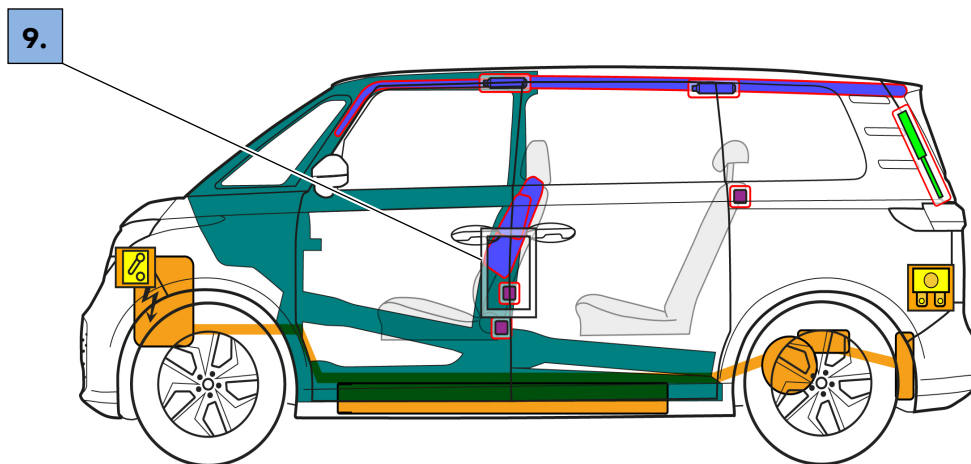







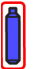

400 V
LI ION

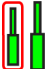

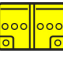
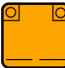
Note: The illustration shows the maximum possible range of equipment.

	Airbag		Stored gas inflator		Seat belt pretensioner		SRS control unit		Gas strut / preloaded spring
	High strength zones		Zone requiring special attention		Battery low voltage		Battery pack, high-voltage		High voltage power cable
	Low voltage device that disconnects high voltage		Fuse box disabling high voltage		High voltage component				

1. Identification / recognition



The electric motor is silent. The indicator on the instrument cluster (power meter) indicates whether the electric drive is switched "OFF" or "READY" for operation.

Logo



Charging connection



2. Immobilization / stabilization / lifting

Immobilize the vehicle

Apply the parking brake



Lifting points

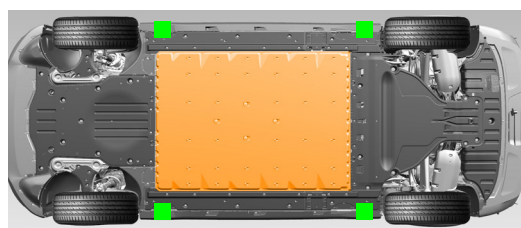

 suitable lifting points

 High-voltage battery

Turn off the ignition (Powermeter "OFF")

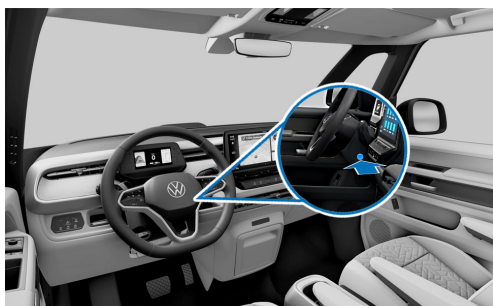

Press the START-STOP button without depressing the brake pedal



3. Disable direct hazards / safety regulations

In the event of an accident in which the airbags are deployed, the high-voltage system will be automatically deactivated. The high-voltage system is de-energised approx. 20 seconds after deactivation.



Do not touch, cut or open high-voltage components and high-voltage batteries!
Wear appropriate protective equipment!

For all other cases, the high-voltage system can be deactivated as follows:



Option 1: From the engine compartment

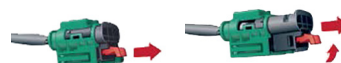
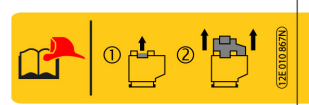
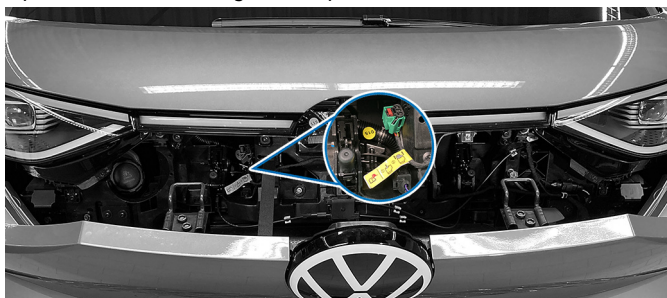

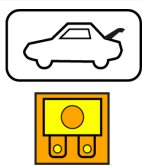

Option 2: from the hold

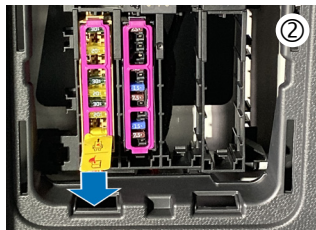
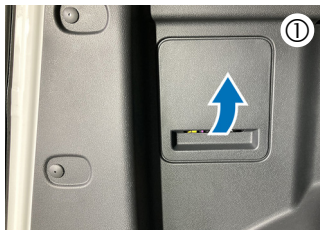

1. Remove the cover on the left side panel
2. Pull fuse (yellow flag)



Disconnect the 12-volt battery

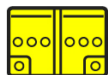

In the footwell under the driver's seat

1. Move the driver's seat forward
2. Remove cover

3. Disconnect the negative (-) terminal of the battery

The 12-volt vehicle electrical system voltage is u. a. used for unlocking and opening electrically operated doors and flaps as well as electric seat adjustment.

Disconnect from the charging station (emergency release)

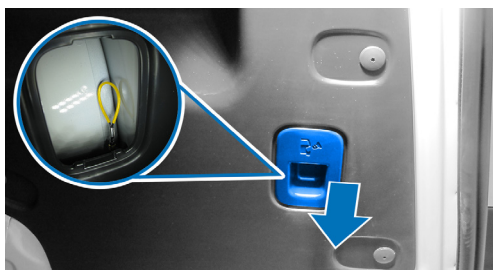
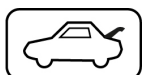

1. Remove right side panel
2. Locate the emergency release yellow loop
3. pull loop

4. Access to the occupants

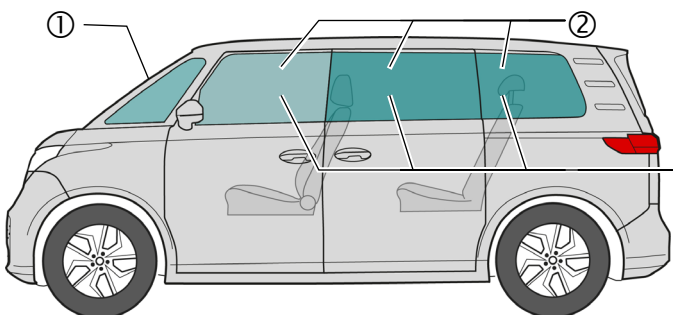

Glas types:

- ① Laminated safety glass
- ② Toughened safety glass
- ③ Optionally composite safety glass

In the event of an accident with airbag deployment, electrically operated doors and flaps are automatically unlocked.

5. Stored energy / liquids / gases / solids



12 V



LI ION



400 V



If coolant escapes from the battery cooling system, there is a risk of a thermal reaction in the high-voltage battery.
Monitor the temperature of the high-voltage battery!



6. In case of fire



Lithium-ion batteries can become damaged or improper
Use promptly or with a delay to ignite or after the Ignite fire fighting again!
Wear appropriate protective equipment!



7. In case of submersion

After rescuing the vehicle from the water, deactivate the high-voltage system (see Chapter 3) and allow the water to drain. Wear appropriate protective equipment!

8. Towing / transportation / storage



Lithium-ion batteries can self-ignite, or re-ignite after a fire has been extinguished.
Wear appropriate protective equipment!



If the vehicle has been involved in an accident or if the high-voltage battery is damaged or unstable: Deactivate the high-voltage system (see Section 3). Park the vehicle at a safe distance, at least 5 m, from buildings and other vehicles (quarantine area).



Do not tow a vehicle that has been involved in an accident on its drive axles.



9. Important additional information

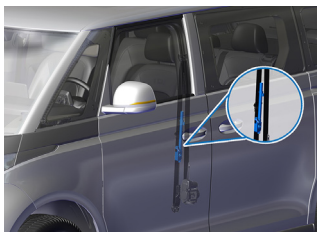

The belt tensioners can be damaged when cutting through the B-pillar!

10. Explanation of pictograms used

flammable	explosive	corrosive	Hazards to the human health	Environmental hazard	Electric vehicle	High voltage warning	Caution, danger
Use water to extinguish the fire	Dangerous voltage	Remove smart key	Use thermal Infrared camera	Release the bonnet	Release the boot		